

# PBタイプ (プリント基板型トランス)

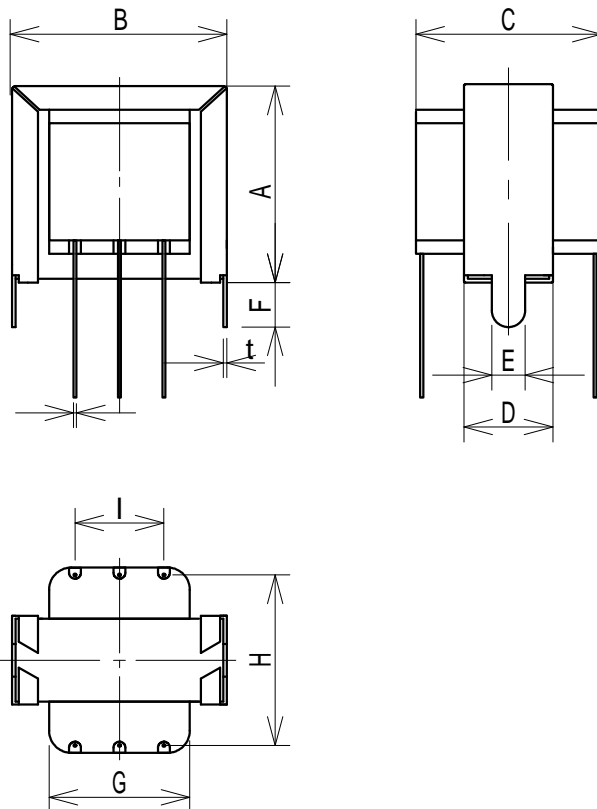

型名	A $\pm$ 1	B $\pm$ 0.5	C Max	D Max	E $\pm$ 0.2	F $\pm$ 0.5	G Max	H	I	t		
PB-1039	8.5	11.0	11	5.0	2.0	4.0	9.5	8.0	4	0.3	0.4	
PB-1238	10.0	13.0	13	5.0	2.0	4.0	11.0	9.5	6	0.3	0.4	
PB-1453	11.0	15.0	15	6.5	2.0	4.0	12.5	12.0	6	0.3	0.4	
PB-1653	14.5	17.0	16	6.5	2.0	4.0	12.5	12.0	6	0.3	0.4	
PB-1953	16.0	20.0	18	7.0	2.0	5.0	14.5	14.0	8	0.3	0.5	
PB-2465	19.0	25.5	22	8.0	2.5	5.0	18.5	17.5	10	0.4	0.5	
PB-2811	26.5	29.5	27	13.5	4.5	6.6	22.0	22.5	12	0.4	0.6	28-9
PB-3510	31.0	36.5	31	13.0	5.0	7.0	27.0	24.0	12	0.5	0.6	35-3-02